

FOR SALE OR LEASE > OFFICE SPACE

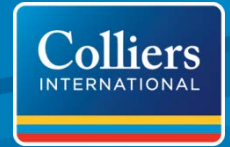

Shiloh Crossing Professional Park

289-297 SHILOH CROSSING DRIVE, AVON, IN



Property Highlights

- > Own or lease your own luxury office suite
- > Sale Price: \$125,000/Suite
- > Lease Rate: \$11.25 psf NNN
- > Suites available ranging \pm 1,212 SF – 4,848 SF
- > Unit 297: \pm 1,212 SF now available – Move in Ready
- > Great access to US 36 & Ronald Reagan Parkway (Ronald Reagan Parkway open southbound to I-70 at Plainfield)
- > Close to amenities including restaurants, shopping and daycare
- > Located in Hendricks County, the second fastest growing county in Indiana
- > AADT on Rockville Road/US 36: 35,158 vehicles

DEMOGRAPHICS

	1 Mile	2 Miles	3 Miles
2013 Population	51,107	135,345	403,278
2018 Population	52,926	141,063	419,255
2013 Total Households	18,609	52,613	153,900
2018 Total Households	19,189	54,653	159,724
2013 Average Household Income	\$69,708	\$66,633	\$62,526
2018 Average Household Income	\$80,670	\$77,472	\$73,037
Average Household Size	2.72	2.54	2.57

STEPHEN DAUM
317 713 2144
stephen.daum@colliers.com

COLLIERS INTERNATIONAL
241 N Pennsylvania St, Suite 300
Indianapolis, IN 46204
colliers.com

Site Plan & Aerial Map

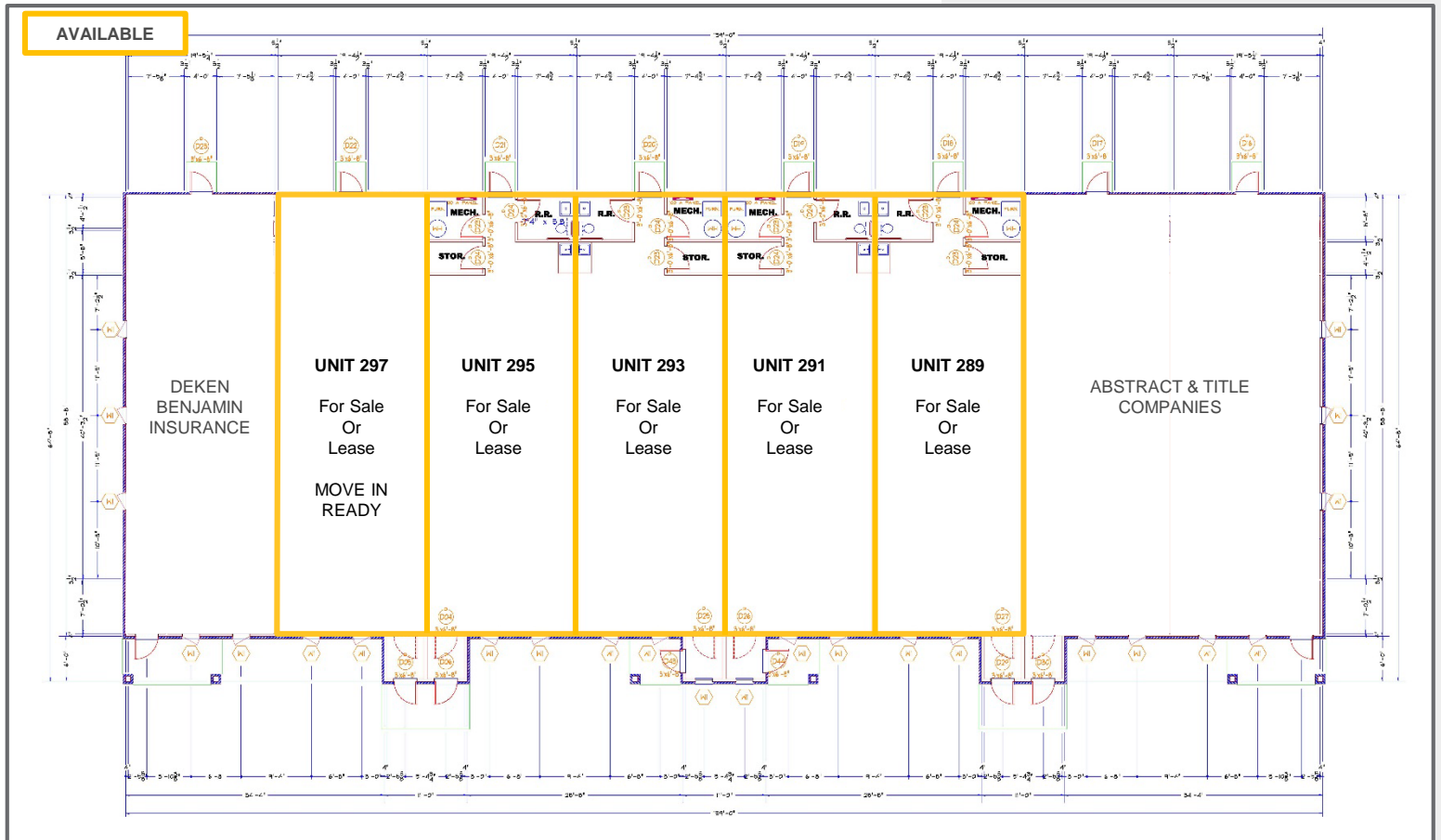

Contact

STEPHEN DAUM

317 713 2144

stephen.daum@colliers.com

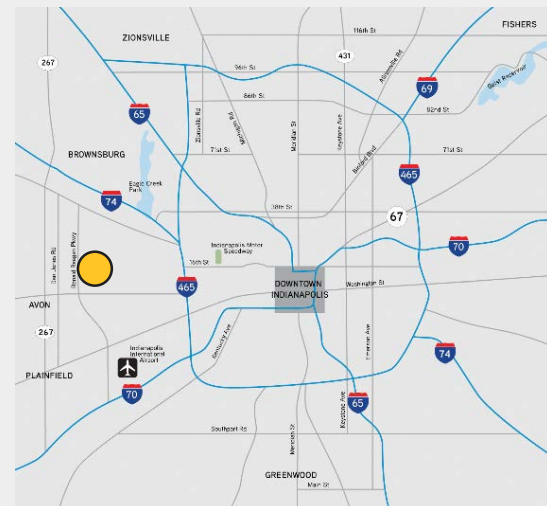

This document has been prepared by Colliers International for advertising and general information only. Colliers International makes no guarantees, representations or warranties of any kind, expressed or implied, regarding the information including, but not limited to, warranties of content, accuracy and reliability. Any interested party should undertake their own inquiries as to the accuracy of the information. Colliers International excludes unequivocally all inferred or implied terms, conditions and warranties arising out of this document and excludes all liability for loss and damages arising there from. This publication is the copyrighted property of Colliers International and/or its licensor(s). ©2015. All rights reserved.

